

## NC Cattle Industry Assessment Referendum Vote Set for October 4

This is a release from the Anson County Cooperative Extension: The North Carolina Cattlemen's Association (NCCA) has announced that the N. C. Cattle Industry Assessment referendum vote will take place on October 4, 2018. The North Carolina Cattlemen's Association will conduct a referendum to continue the N. C. Cattle Industry Assessment. Arrangements have been made with the North Carolina Cooperative Extension Service to facilitate the voting. The Extension offices in each county will be the polling places.

John Langdon, president of the North Carolina Cattlemen's Association, said that the referendum will be to assess all cattle sold and marketed in North Carolina one dollar per head for the purposes of advancing the cattle industry in the state. The money collected will continue to fund the following five areas: youth programs, cattle research, education, promotion of North Carolina cattle and beef, and issues management. The North Carolina dairy industry will also benefit from the funds collected, as a portion of the income will be allocated to the same areas within the dairy sector.

The referendum would continue the original state assessment program, which was first established in 1957. The national beef checkoff assessment of one dollar per head will still be collected and will be used according to the guidelines set forth in federal law. According to Mr. Langdon, "The national beef checkoff does a tremendous job of promoting beef and the beef industry, returning \$11.20 per dollar invested; however, these funds cannot be used for many of the production and regulatory-oriented issues facing the industry today. The N. C. Cattle Industry Assessment Referendum would allow producers to continue to provide funds that would be controlled totally by the North Carolina beef and dairy producers to promote our product, our youth, our industry, and to provide research and advocacy to protect their way of life." Since the assessment was reinstated on January 1, 2017, research and education projects have been funded to deal with production issues facing North Carolina cattlemen in the areas of management, forage production, feed efficiency, and general input reductions. In addition, we have been able to provide additional services in issues management to help the public have a better understanding of our industry and training for farmers to help them to be more efficient and provide more research-based management for them and the cattle in their care. Youth programs have been a huge beneficiary of the investments from the assessment as we have been able to support livestock schools, judging contests, Skillathon contests, leadership development, and the very popular Bryan Beef Industry Tour, among many others.

Bryan Blinson, executive director of the North Carolina Cattlemen's Association, states that, "The assessment will be for a period of six years with a recurring referendum if requested. Also, Mr. Blinson states that producers will be eligible for a full refund of their North Carolina assessment by request within 60 days of the sale of the animal with proof of sale. This is a provision that is not available in the national program due to federal law."

All cattle owners who are at least 18 years of age as of October 4, 2018, will be eligible to vote. Voting will take place at the North Carolina Cooperative Extension offices. All eligible voters must vote in their county. Absentee ballots may be obtained by contacting the North Carolina Cooperative Extension office. The North Carolina Cattlemen's Association can assist with directing you to your local office.

For additional details on voting procedures or funding information, please contact your local county office of the North Carolina Cooperative Extension Service, the North Carolina Department of Agriculture and Consumer Services, or the North Carolina Cattlemen's Association.

### Market on Market this Saturday in Cheraw!

Market on Market will be this Saturday, August 18 from 9 a.m. to 1 p.m. in downtown Cheraw. Local farmers from the Cheraw Farmer Market will bring their produce to the downtown area for purchase. Roadie the Puppet Dog and his friends from the Columbia Marionette Theatre return from 10 a.m. until 12:30 p.m.

A variety of food items will be available for purchase from restaurants. River's Edge will have their famous home churned ice cream and chicken salad at the restaurant. One-Fifty-Ate Bakery will be serving baked goods that morning. The Wine Factory will be open for brunch 10:30 a.m. to 12:30 p.m.

The Cheraw Merchants Association will present Ping Pong Ball Toss during the Market. The toss will be at 11 a.m. at the Theatre on the Green Area. Participants can vie for gift certificates and prizes from local merchants.

Contact the Cheraw Certificates Commission for additional information about the Market event. The office number is 843.537.8420 x 12.

### Anson Middle School Athletics for Fall 2018-19

- **Golf** - Tryouts will begin on Wednesday, August 29, 4:15 until 5 p.m. at Twin Valley Golf Club
- **Cross Country** - Tryouts will begin on Monday, September 10, 3:45 until 5:30 p.m. at Anson Middle School.
- **Volleyball** - Tryouts will begin on Wednesday, August 29, 3:45 until 5:30 p.m. at Anson Middle School.
- **Football** - First practice will be on Monday, August 20, 4 until 6 p.m. at Anson Middle School.
- **Cheerleading** - To be announced

You must have a current physical to participate. Contact John Martin if you have any questions at [martin.john@anson.k12.nc.us](mailto:martin.john@anson.k12.nc.us).

### Do You Have a Coat or Blanket You Would Like to Donate?

The Faith-Based Center of Hope continues their "Warm Coats, Warm Hearts" program throughout the year. They distribute coats and blankets to several of the churches and schools in Anson County as well as directly to those people in need. Now that winter is over, do you have a coat or blanket that you can contribute to this cause?

To donate coats and blankets or to request help, please contact Vance Sturdivant at 704-848-4412.

### RED HILL BAPTIST CHURCH WEEKDAY CHILDREN'S MINISTRY

Registering Now for 2018-19 School Year

**OPEN HOUSE • AUGUST 23 • 6-7pm**

Serving children ages 1 year to pre-K  
Tuesday through Thursday • 8:30am-12 noon

Visit [www.redhillbaptist.org](http://www.redhillbaptist.org) for more information or to obtain a registration form

You may also contact Stephanie Maner at 704-695-6605 or [smaner@redhillbaptist.org](mailto:smaner@redhillbaptist.org)

RED HILL BAPTIST CHURCH • POLKTON

### 2018 SCOTBILT 32'x76' HOME

5 Bedroom • 3 Bathroom \$79,900 Price includes delivery & set up, heat pump, steps, vinyl skirting and electrical meter & base.

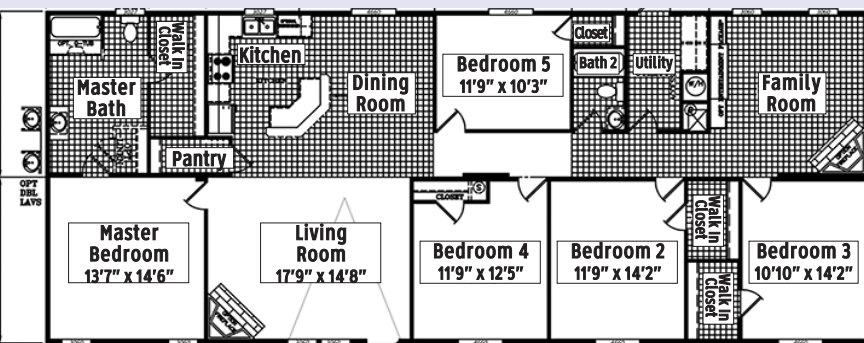

**CHARRIETTE HOMES**

3067 Highway 9  
Cheraw, SC  
843-253-5286  
[www.CharrietteHomes.com](http://www.CharrietteHomes.com)

**"Jesus God First Company"**

**Clayton homes**  
**SCHULTZ**

**HASELDEN HOMES 843-921-9173**

3692 Highway 9 in Cheraw [www.HaseldenHomes.com](http://www.HaseldenHomes.com)

**ScotBilt HOMES, INC.**

### COMMUNITY MEDICAL, PA OF MARSHVILLE

Community Medical, PA of Marshville and Dr. Gary Henry, along with Brandi Thomas, FNP-C, Family Nurse Practitioner, welcomes new patients

WE ARE ACCEPTING NEW PATIENTS & ACCEPT MOST ALL INSURANCES.

We are here to help you! Call to arrange your appointment today!

Both providers are Federally Certified Medical Examiners and perform DOT exams and Urine/Hair drug testing on-site five days a week.



Dr. Gary Henry



Brandi S. Thomas, FNP-C

COMMUNITY MEDICAL, PA Family Practice / Medical Care  
520 West Main Street, Marshville • 704-624-3388 or 704-694-3339 • Fax 704-624-3390

### PLAY PRESENTED BY THE ANSONIA THEATRE Two Weekends: Aug 17-19 & Aug 24-26

**TICKETS ON SALE NOW!**

Directed by Tommy Wooten  
Music by Gail Litaker  
Choreography by Gina Clarke

Featuring professional actor/singer Anachebe Asomugha

704-694-4950 [ansoniatheatre.com](http://ansoniatheatre.com)

# BIG RIVER

THE ADVENTURES OF HUCKLEBERRY FINN

**JOHN DEERE**

**QUALITY EQUIPMENT, LLC**

Savings so you're ready for the season...

### GEAR UP 4 FALL

**\$99/MONTH** 1023E SUB-COMPACT UTILITY TRACTOR

- 22.4 hp Diesel Engine
- 6-YEAR POWERTRAIN WARRANTY\*
- 0% FOR 84 MONTHS\*



**\$139/MONTH** 3025E COMPACT UTILITY TRACTOR

- 24.7 hp Diesel Engine
- 6-YEAR POWERTRAIN WARRANTY\*
- 0% FOR 84 MONTHS\*

...That's Quality.

POLKTON  
7256 US Hwy 74 West  
704-694-6516

GET A QUOTE at [QualityEquip.com](http://QualityEquip.com)

\*Offer valid on new 1023E Compact Tractor purchases made between August 1, 2018 and October 26, 2018. Subject to approved installment credit with John Deere Financial, for commercial or consumer use only. Up to a 20% down payment may be required. Example: Based on a purchase of \$10,405 with \$2,081 down payment, monthly payment of \$99 at 0% APR for 84 months. Taxes, freight, set up and delivery charges could increase the monthly payment. Valid only at participating U.S. dealers. Price and model availability may vary by dealer. \*Offer valid on new 3025E Compact Tractor purchases made between August 1, 2018 and October 26, 2018. Subject to approved installment credit with John Deere Financial, for commercial or consumer use only. Up to a 20% down payment may be required. Example: Based on a purchase of \$14,556 with \$2,911 down payment, monthly payment of \$139 at 0% APR for 84 months. Taxes, freight, set up and delivery charges could increase the monthly payment. Valid only at participating U.S. dealers. Price and model availability may vary by dealer. \*All Compact Utility Tractors purchased new from an authorized John Deere Dealer come standard with a 6-year/2000-hour (whichever comes first) Powertrain Warranty. See the Limited Warranty for New John Deere Turf & Utility Equipment at dealer for details. †Manufacturer's estimate of power (ISO) per 97/68/EC. \*Offer ends 10/26/18. Subject to approved installment credit with John Deere Financial. Some restrictions apply; other special rates and terms may be available, so see your dealer for details and other financing options. Valid only at participating US Dealers.